

SIROFLEX[®]

GARDEN DIVISION



"Capillary" watering system with module distributor for terraces, gardens, vegetable plots and greenhouses.





"Capillary" watering system with module distributor for terraces, gardens, vegetable plots and greenhouses.

By watering each plant at their base, the water will reach the roots directly and will save water.

It will also cut down on the problem created by too much watering (proliferation of weeds and insects) and will help limit evaporation.

With the **SIROFLEX**

capillary watering system,

you can water plants from "drop to drop" to approx. 3 litres per minute depending on the needs of each individual plant and the quantity of water available.

This easily assembled functional and inexpensive system comprises of limited number of components for quick and easy installation:

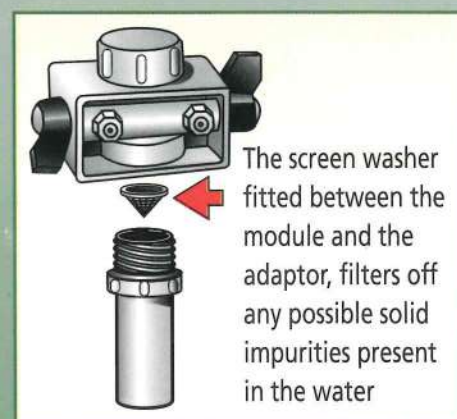
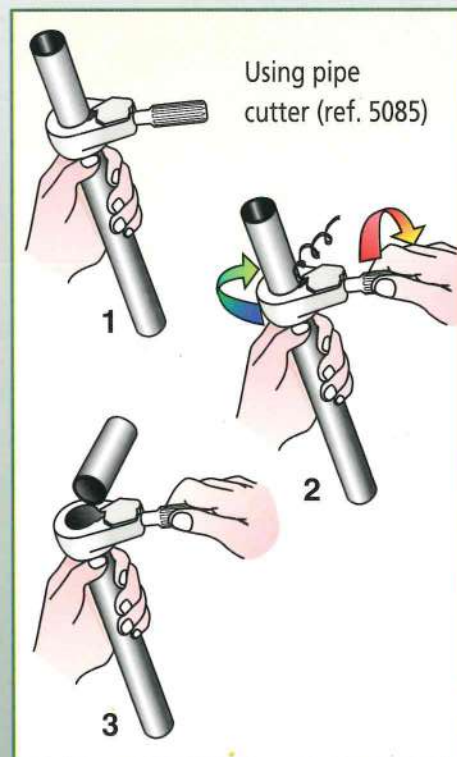
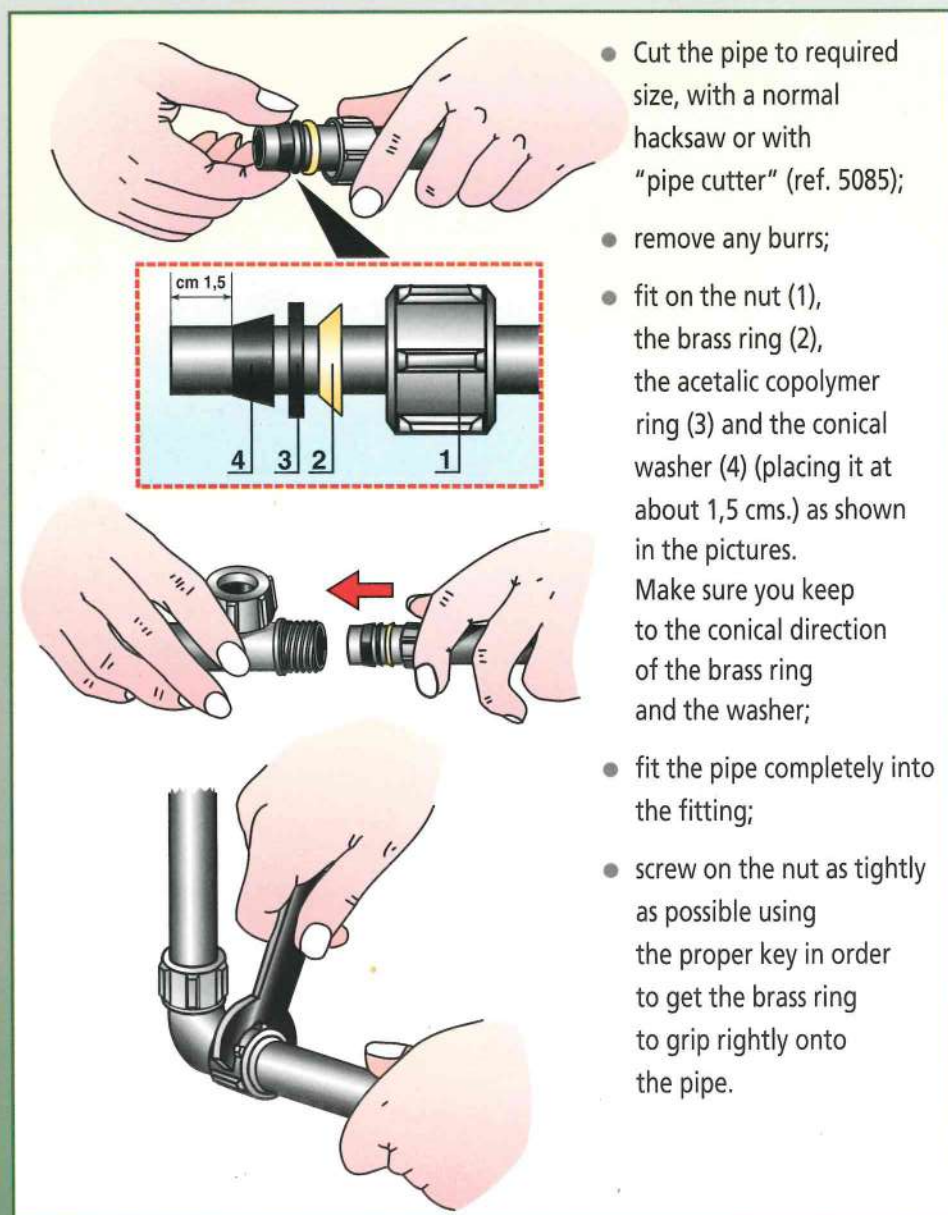

- a series of polypropylene fittings and relevant rigid pipe 20 mms. in diameter to set up the system;
- module distributor with two outlets with taps for water supply (ref. 5001);
- mini sprinkler on spike (ref. 5010) with relevant 4 x 6 mms. capillary hose, "T" junction (ref. 5022), hose mender (ref. 5032).

The module distributor can feed up to **four** mini sprinklers via "T" junctions. When only a **"drop to drop"** is requi-

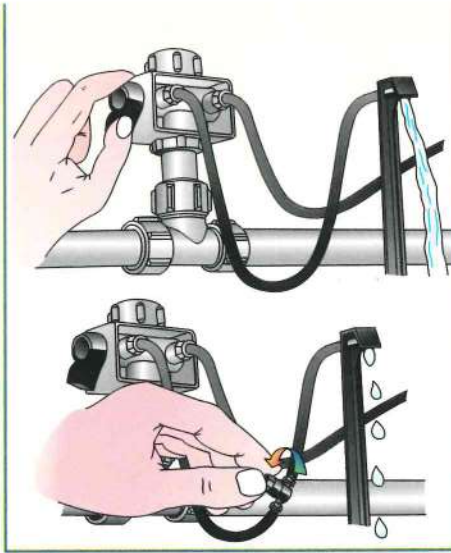

red the flow regulator (ref. 5018) on the capillary hose of each mini sprinkler should be used. If it is not necessary to water each plant individually but only a small lawn, strawberry bush or a vegetable patch, the micro-sprayers should be used instead of the mini

sprinklers. These atomize the water and cover the surface area to be watered in different parts, at 90° (ref. 5013), at 180° (ref. 5014), at 360° (ref. 5015). Manually screwed onto their support frame (ref. 5017) and lightly tightened with the key (ref. 5016), they are attached to the spike (ref. 5011). If the spike of the micro-sprayer needs to be lengthened this can be done by adding a second spike (ref. 5012) to the double ring and so on.

Connection of the capillary hose to the modules.



Assembling of the micro-sprayers

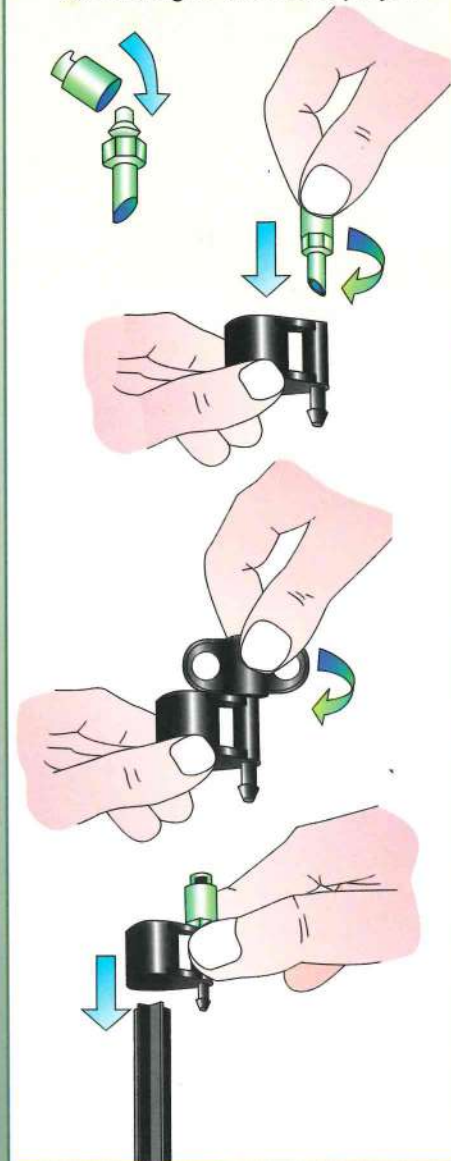

Use and setting of extender spike

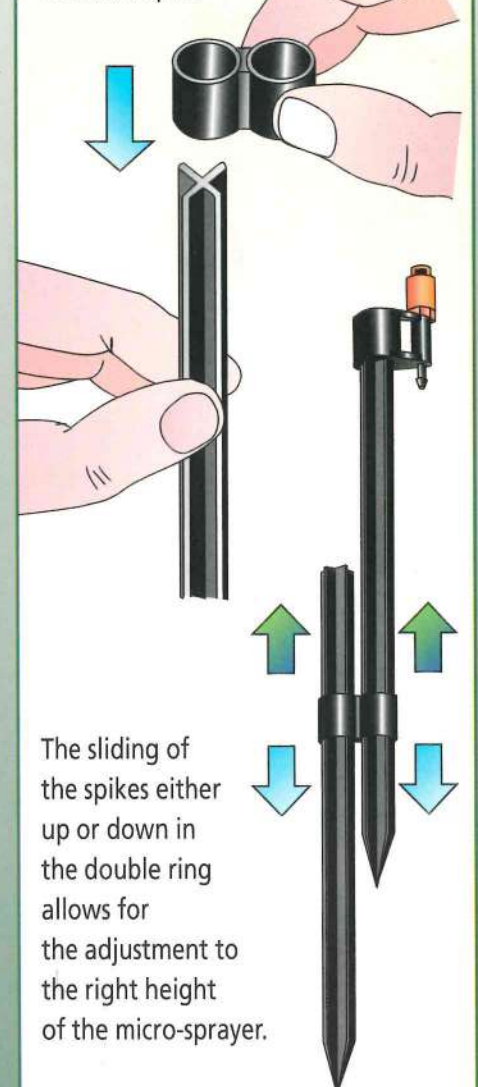

SIROFLEX®
GARDEN DIVISION

Italian ideas and products



When the micro-sprayers are used, it is advisable to apply the flow regulator (ref. 5018) to the capillary hose placing it near each micro-sprayers; this allows for a more balanced distribution of the water.

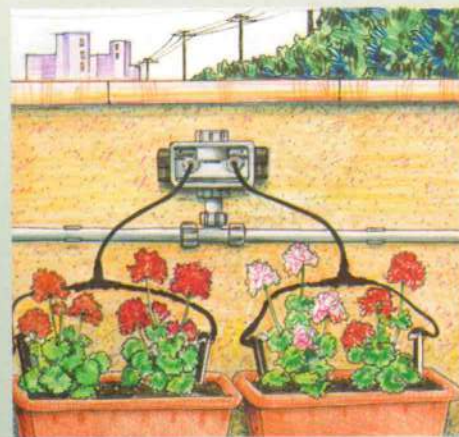
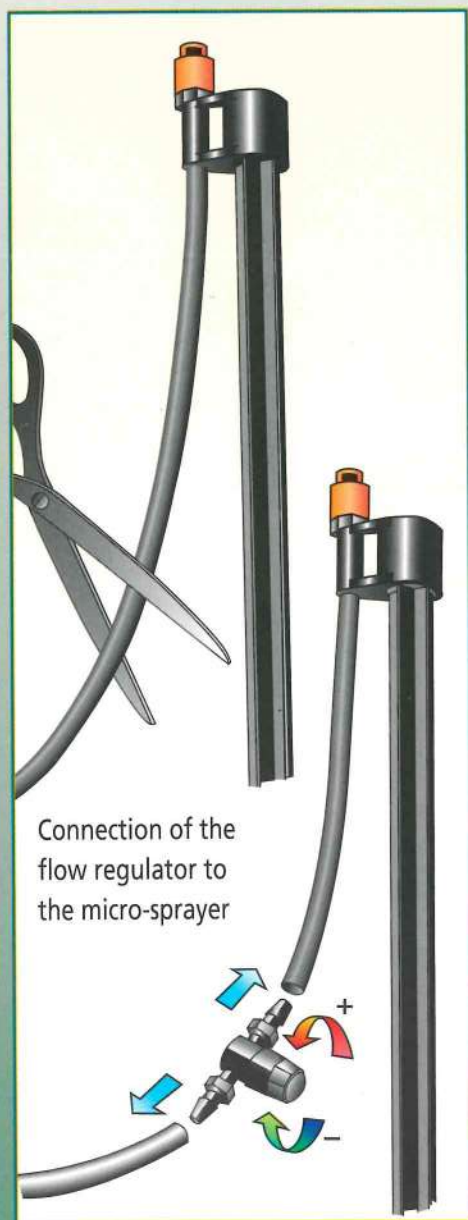
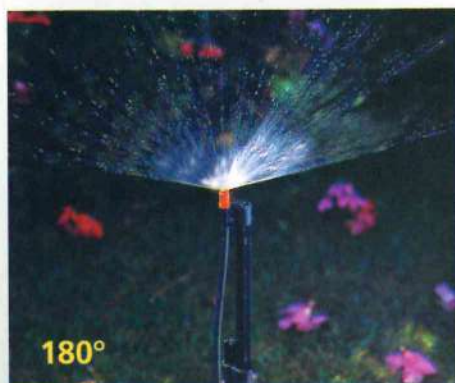

The operating lifespan of the irrigation system will be much longer if:

- the amount of water distributed to the mini sprinklers and micro-sprayers is carefully monitored;
- whenever the water is not smooth, check carefully and clean up the screen washer, which is situated between the module and the adaptor;
- if the mini sprinkler or the micro-sprayer becomes obstructed, please check that no insect has blocked the water passage;
- if you are not using the watering

system during the winter months, discharge the remaining water.

In this respect, it is necessary when installing the system, that you have made provision for the insertion of the closing cap (ref. 5074) at the terminal, which has been designed for this purpose.

If the system is automated, turn off the main tap in winter and remove the battery from the Timer.

In very severe weather it is advisable to remove the apparatus itself from its exterior position in order to avoid any damage caused by cold and ice.



The automation of the system is achieved by using the Electronic Timer 5500

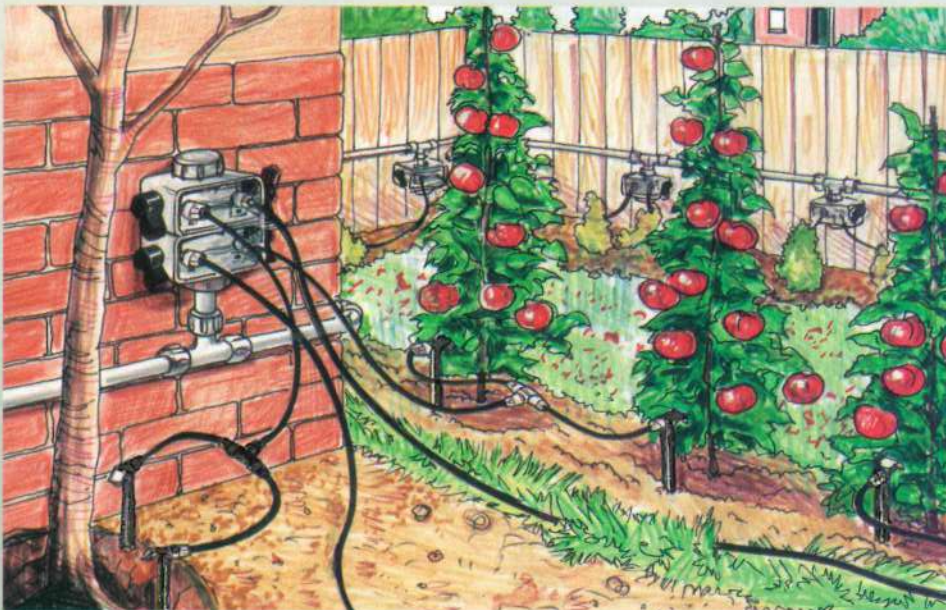

In the capillary watering system you can simultaneously use the mini sprinklers and micro-sprayers.





Components



ref. 5001
Module distributor (patented)
3/4" female - 3/4" male
with two taps.
*Can feed from 2 to 4 mini
sprinklers or micro-sprayers.*

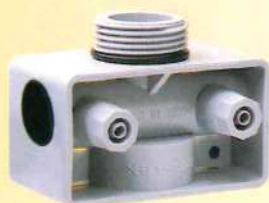

ref. 5004
DISCONTINUED



ref. 5010
Mini sprinkler on spike.
*Supplies through the water
flow regulator can be
regulated from a "drop"
to 3 litres per minute.*

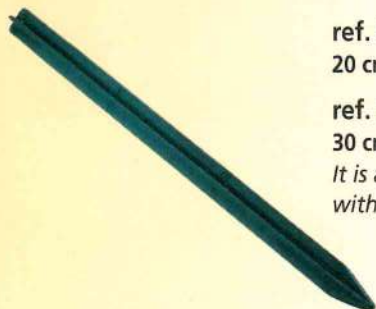

ref. 5011/20
20 cms. spike.

ref. 5011/30
30 cms. spike.
*It is also used as an extender
with the double ring.*



ref. 5012
Double ring.
*Essential for the use of the
spike (ref. 5011) as an
extender.*



ref. 5013
Micro-sprayer at 90°
(green).
*To screw onto the support
(ref. 5017).*



ref. 5014
Micro-sprayer at 180°
(orange).
*To screw onto the support
(ref. 5017).*



ref. 5015
Micro-sprayer at 360°
(black).
*To screw onto the support
(ref. 5017).*



ref. 5016
Key.
*To be used to tighten the
micro-sprayer to its support.*



ref. 5017
Support for micro-sprayer.
*Accompanied by
the micro-sprayer and lined
to the capillary hose 4 x 6.
To be placed on the spike
(ref. 5011).*



ref. 5018
Water flow regulator
for capillary hose 4 x 6.



ref. 5022
"T" junction for
capillary hose 4 x 6.



ref. 5032
Capillary hose mender 4 x 6.



ref. 5035
3/4" female cap for
module distributor.



ref. 5070
pipe mender for 20 mms.
diameter pipe.



Capillary hose Ø 4 x 6 mms.
ref. 5040
100 mts. roll
ref. 5045
50 mts. roll
ref. 5048
25 mts. roll



ref. 5074
End cap for 20 mms.
diameter pipe.



ref. 5050
Non-toxic PVC rigid pipe
20 mms. external diameter
(2,50 mts. length).



ref. 5075
3/4" male adaptor
with screen washer.
*Must be used to attach the
module distributor to the
"T" junction (ref. 5060).*



ref. 5053
Pipe clip.
*To grip the 20 mms. pipe
(if it is necessary).*



ref. 5080
Key to tighten the nuts
of the fittings.
For 20 mms. diameter pipe.



ref. 5055
3/4" female fitting for 20 mms.
diameter pipe.
*Used to connect the system
to main tap (or to the 5500
Electronic Timer in the
automated system).*



ref. 5085
Pipe cutter.
*Useful for cutting the 20 mms.
diameter rigid pipe.*



ref. 5060
"T" junction for 20 mms.
diameter pipe.
*Can be used to attach
the module distributor
to the system or as a mere
derivation.*



SPARE PARTS
ref. 5062
Rubber conical washer.
ref. 5063
Acetalic copolymer ring.
ref. 5064
Brass ring.



ref. 5065
90° elbow for 20 mms.
diameter pipe.

ref. 5066
135° elbow for 20 mms.
diameter pipe.



ref. 5500
Electronic Timer powered by
one 9V alkaline battery.
*For the automation of the
watering system.*

Electronic Timer 5500

For the automation of any kind of watering system

Our experience in the field of watering systems has allowed us to come up with an electronic timer that will solve the problem concerning automatic watering of terraces, gardens, vegetable plots and greenhouses.

Our system **guarantees** the following:

- a very simple electronic system where the day, the time and the duration of watering can be selected by simply turning 3 small knobs;
- advanced technology which guarantees total automation, maximum precision and long lifespan (1 year warranty);
- it operates perfectly on both low and high water pressures.



PRODUCT FEATURES

- Liquid crystal clock.
- Can be used once from 1 to 55 minutes daily, every other day, every 3, 5, 7 days.
- Powered by one 9V alkaline battery.
- Low consumption microprocessor.
- Works at pressure from 0 to 8 bars.
- Can be operated manually without disrupting the memorized computer programme.
- Entry and exit 3/4" thread.

INSTRUCTIONS

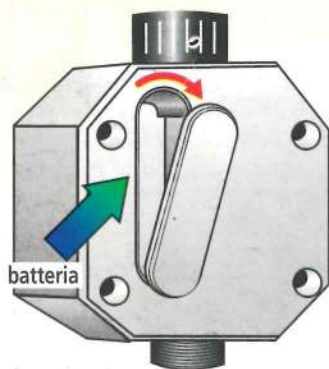

- Insert battery.

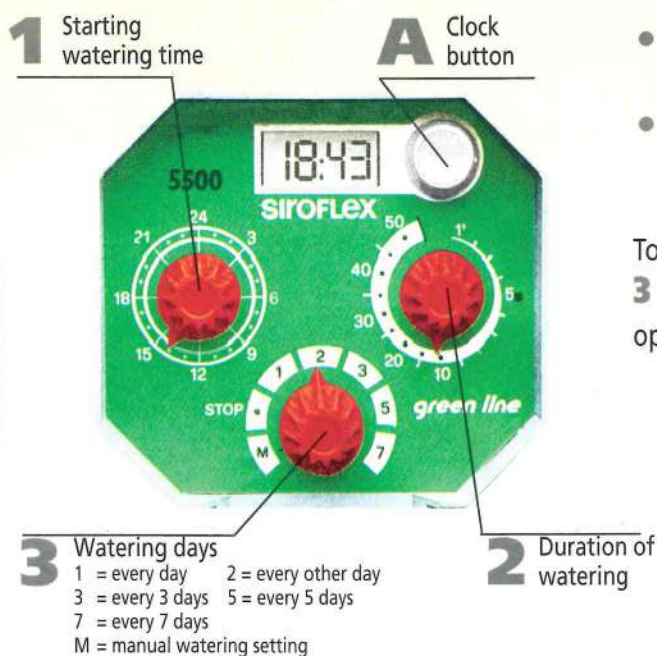

- Set the clock to local time by pushing button **A**.
- Choose watering programme by setting the knob **1**, duration **2**, day **3**.

To disconnect the timer set the knob **3** to STOP; if you want to manually operate the timer set it to "M".

SIROFLEX
GARDEN DIVISION



Italian ideas and products